



5 Greens Cottages Gallants Lane, East Farleigh, ME15 0LH
Price £285,000

*****NO FORWARD CHAIN*** TWO BEDROOM CHARACTER COTTAGE IN THE SOUGHT AFTER VILLAGE OF EAST FARLEIGH**

Situated in semi rural village of East Farleigh, this charming home it is ideally located for the commuter with a choice of mainline services to London within a short drive including Maidstone East and West, Paddock Wood, Staplehurst and Marden Stations. The general area is well served with a wide range of amenities including Tesco Express, Post Office and several excellent pubs including The Walnut Tree, The Horseshoes and The Bull.

The home offers spacious and adaptable accommodation. On the ground floor there is a practical and useful entrance porch, a large living area with log burner and a well appointed kitchen. On the first floor there are two inviting bedrooms and a bathroom suite with an electric shower over the bath.

Outside, there is a neatly enclosed low maintenance garden with shed and log store and a convenient parking space to the rear.

Do not miss your opportunity to own this wonderful home. Call Page and Wells Loose Office today and book your viewing to avoid missing out.



GROUND FLOOR

Porch

Lounge/Dining Room 30'4" x 11'11" (9.25m x 3.65m)

Kitchen

FIRST FLOOR

Bedroom 1 11'11" x 10'2" (3.65m x 3.10m)

Bedroom 2 10'0" x 6'5" (3.05m x 1.98m)

Bathroom

EXTERNALLY

Well Maintained Garden

Shed 7'5" x 5'6" (2.27m x 1.69m)

Log Store

Off Road Parking

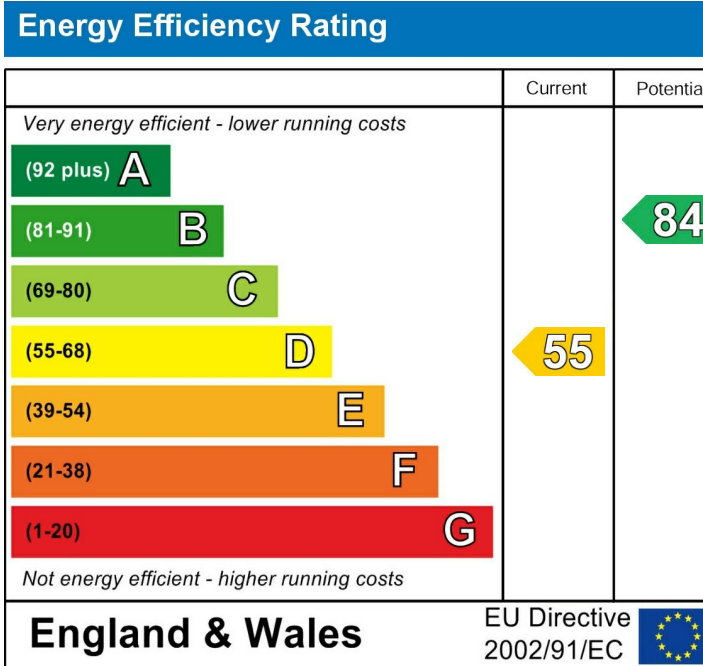

Greens Cottages, Gallants Lane, East Farleigh, Maidstone
Approximate Gross Internal Area
Main House = 659 Sq Ft/61 Sq M
Shed & Log Store = 75 Sq Ft/7 Sq M
Total = 734 Sq Ft/68 Sq M

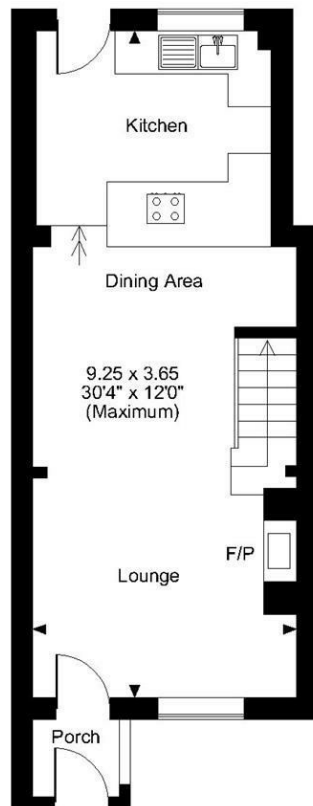
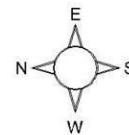

Ground Floor

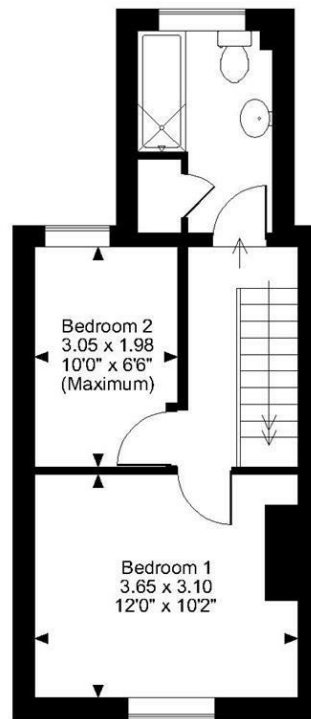

First Floor

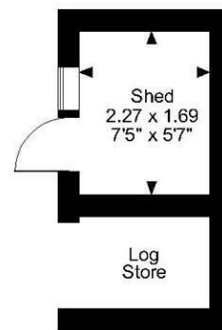

FOR ILLUSTRATIVE PURPOSES ONLY - NOT TO SCALE
 The position & size of doors, windows, appliances and other features are approximate only.
 © ehouse. Unauthorised reproduction prohibited. Drawing ref. dig/8576133/LCO

